

# Installation Instructions

Part Numbers:

**Infiniti FX35**  
**Infiniti FX37**  
**Infiniti FX50**  
**Infiniti QX70**

**75778**  
**44692**  
**87639**

**Do Not Exceed Lower of Towing Vehicle  
 Manufacturer's Rating or**

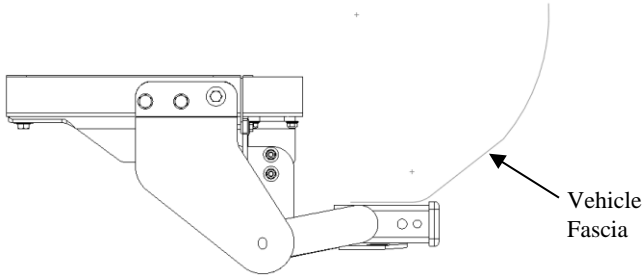

## Hitch Shown In Proper Position

**Equipment Required:** Round file, tape, Short Phillips head Screwdriver, Flat-blade Screwdriver  
**Fastener Kit:** 75778F

**Wrenches:** 10mm, 12mm, 13mm, 14mm, 17mm, 19mm , 9/16"  
**Drill Bits:** 7/16"

Hitch type	Max Gross Trailer WT (LB)	Max Tongue WT (LB)
Weight Distributing	<b>Do Not Use With Spring Bars</b>	
Weight Carrying Ball Mount	<b>4000 (1816 Kg)</b>	<b>400 (182 Kg)</b>

**Wiring Access Location:** SUV3, SUV4

Accessory Rating	<b>C</b>
------------------	----------

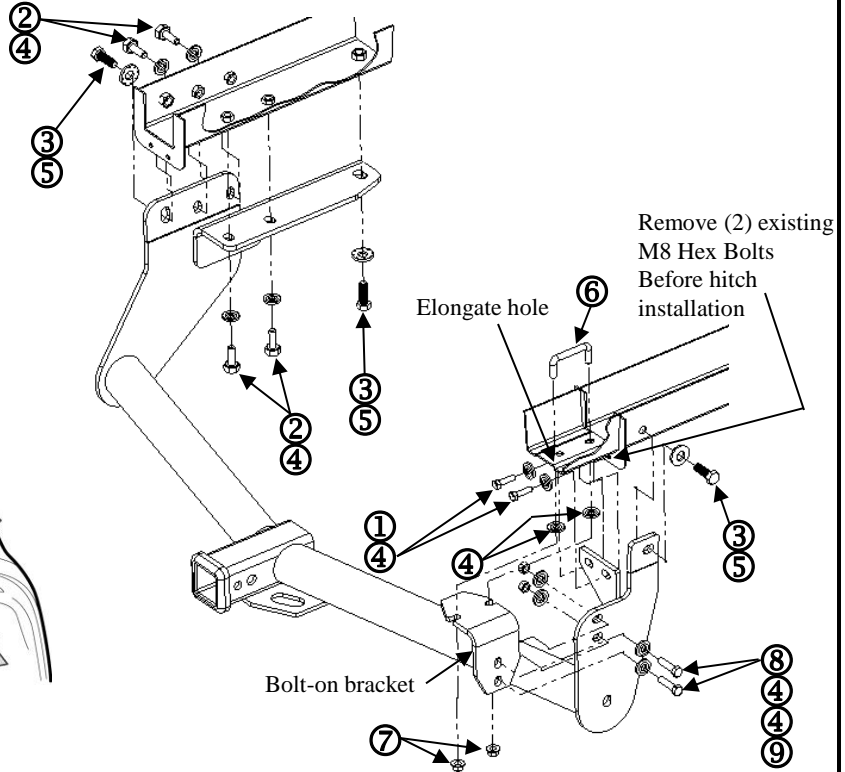
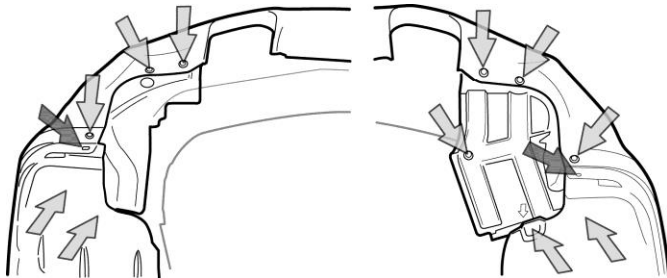
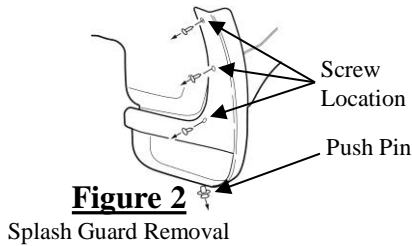

①	Qty. (2)	Hex Bolt M8 x 1.25 x 30mm CL10.9	⑥	Qty. (1)	U Bolt 3/8"-16 GR 5
②	Qty. (4)	Hex Bolt M10 x 1.25 x 30mm CL8.8	⑦	Qty. (2)	Flanged lock nuts – 3/8-16
③	Qty. (3)	Hex Bolt M12 x 1.25 x 35mm CL8.8	⑧	Qty. (2)	Hex Bolt 3/8 – 16 x 1-1/4" GR 8
④	Qty. (12)	Conical Toothed Washer 3/8"	⑨	Qty. (2)	Hex nuts 3/8 – 16 GR 5
⑤	Qty. (3)	Conical Toothed Washer 1/2"	⑩		

**Cequent**



# Installation Instructions

Part Numbers:

**Infiniti FX35**  
**Infiniti FX37**  
**Infiniti FX50**  
**Infiniti QX70**

**75778**  
**44692**  
**87639**

**Do Not Exceed Lower of Towing Vehicle  
 Manufacturer's Rating or**

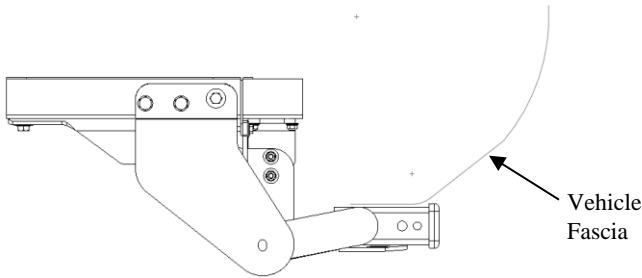

## Hitch Shown In Proper Position

**Equipment Required:** Round file, tape, Short Phillips head Screwdriver, Flat-blade Screwdriver  
**Fastener Kit:** 75778F

**Wrenches:** 10mm, 12mm, 13mm, 14mm, 17mm, 19mm, 9/16"

**Drill Bits:** 7/16

Hitch type	Max Gross Trailer WT (LB)	Max Tongue WT (LB)
Weight Distributing	<b>Do Not Use With Spring Bars</b>	
Weight Carrying Ball Mount	<b>4000 (1816 Kg)</b>	<b>400 (182 Kg)</b>

**Wiring Access Location:** SUV3, SUV4

Accessory Rating **C**

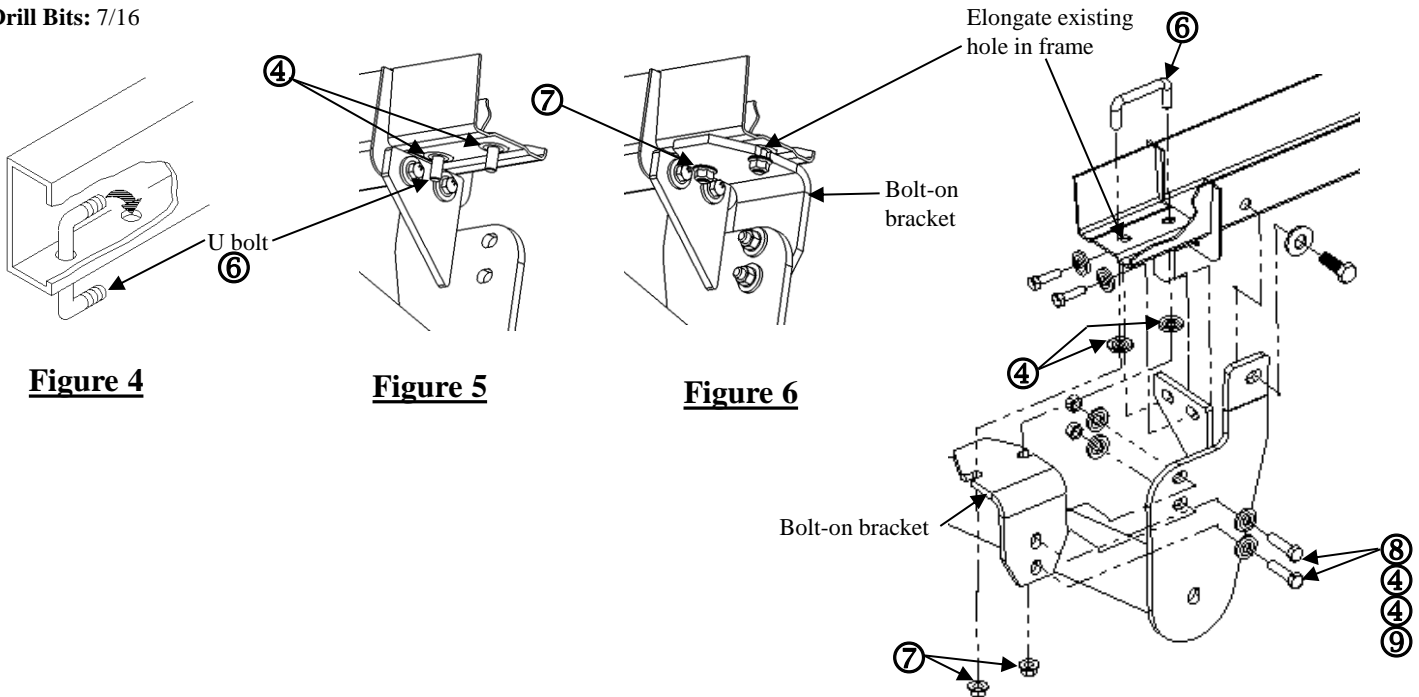

**Figure 4**

**Figure 5**

**Figure 6**

- Remove splash guards from both driver's side and passenger's side wheel wells by removing (3) Phillips head screws and one push pin, each side, as shown in **figure 2**. Retain splash guards and fasteners for reinstallation.
- Remove appearance panels from each side by removing push pins and M6 bolts as shown in **figure 3**, to access vehicle frame rails. Return panels and fasteners to vehicle owner.
- Remove tow hook from driver's side frame rail by removing (4) M10 fasteners. Return tow hook and fasteners to vehicle owner.
- Remove suspension damper on driver's side to allow wrench clearance for forward most fastener.
- On passenger's side, remove (2) M8 hex bolts from bottom flange at end of frame rail (located just rearward of exhaust hanger bracket) as shown and discard.
- Raise hitch into position and install fasteners as shown into existing weldnuts, except for bolt on bracket.
- With a torque wrench tighten all M8 x 1.25 CL10.9 fasteners to 25 Lb.-Ft. (34 N\*M) ; M10 x 1.25 CL8.8 fasteners to 42 Lb.-Ft. (57 N\*M); and all M12 x 1.25 CL8.8 fasteners to 76 Lb.-Ft. (103 N.M)**
- With hitch installed attached, elongate rear most hole in passenger side frame with drill or file. Approx. 1/8". Paint bare metal.
- Install U bolt as shown in **figure 4** and slide conical washers over the bolt to act as a spacers. Tape them in place until the bracket is installed see **figure 5**.
- Install bolt on bracket as shown in **figure 6** with the remaining fasteners noted in the figures.
- With a torque wrench tighten U bolt lock nuts to 35 Lb.-Ft. (47 N\*M) and 3/8-16 grade 8 fasteners to 45 Lb.-Ft. (61 N\*M).**
- Reinstall suspension damper removed in step 4.
- Reinstall splash guards removed in step 1.